

## Where the little things mean everything.

At DoubleTree by Hilton™ London – West End we put the human touch back into your travel experience. It all starts with the warm welcome of a chocolate chip cookie at check-in. Then the caring keeps coming with everything from the luxurious comfort of our stylish guests rooms to our highly-trained staff members who are dedicated to anticipating your needs, so your stay is the best it can be. Come and see us! We always have a cookie with your name on it ready and waiting.

### ACCOMMODATION

DoubleTree by Hilton™ London – West End has a variety of guest rooms that meet every need, from the single business traveller to families. You will enjoy contemporary design, spacious layouts and individual climate control in every room. High-speed internet access is available in all the guest rooms.

Each room is designed to ensure your every comfort.

- 237 renovated guest rooms
- Complimentary WiFi access throughout
- All rooms with LCD HD TV offering a variety of global TV channels
- Work desk with adjustable lighting
- Direct dial telephone
- Individual climate control
- Hairdryer, iron and ironing board
- 24 hour in-room dining available
- Our accessible rooms offer all amenities of our standard guest rooms, plus a range of accessible features
- An exclusive Premium Deluxe Wing and multi-roomed apartments with private access

### AT YOUR SERVICE

- Same-day laundry
- Concierge service
- 24hrs Business Centre
- State-of-the-art fitness centre

### LOCATION

DoubleTree by Hilton London – West End is ideally located in London's historic Bloomsbury district, between Holborn and Russell Square Underground Stations.

Our hotel offers business and leisure travellers the perfect place to stay, just a stone's throw from the British Museum and walking distance to top attractions such as Covent Garden, the West End and the shops of Oxford Street. With great transport links, easily accessible by tube, rail and bus, you are never too far from where you want to be in London.

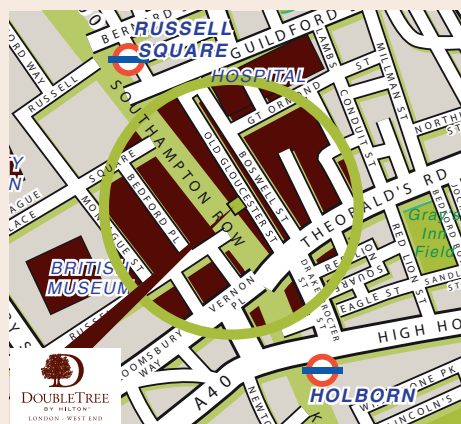

### DINING

No matter what you're hungry for, you'll find our kitchen is always open. Whether you're looking for breakfast, lunch, dinner, an in-between snack, ordering room service or winding down in our restaurant or bar, you'll find we always have something fresh, tasty and healthy on the menu.

- **The Level Restaurant**  
Serving the famous 'DoubleTree' breakfast and available for private dining.
- **Bar92**  
An ideal place for a light snack, Starbucks coffee or a refreshing glass of wine - experience the relaxed atmosphere, free WiFi and friendly service. Open from 7am
- **Restaurant92**  
Open for lunch or dinner, the restaurant offers an extensive à la carte menu comprising of international and traditional English dishes
- **In-room dining available 24hrs**

### HILTON HONORS™

Hilton Honors is more than just a guest loyalty program. It believes in honoring members with exciting, authentic and extraordinary possibilities. In fact, at nearly 5,000 properties in 103 countries and territories, Honors gives you access to a world of experiences worth sharing. Join for free today by visiting [www.honors.com](http://www.honors.com).

Hilton Honors™ membership, earning of Points & Miles® and redemption of points is subject to Honors Terms and Conditions.





### SURROUNDING ATTRACTIONS

- British Museum - 0.2 miles
- Covent Garden - 0.7 miles
- Leicester Square - 0.9 miles
- Oxford Street - 0.9 miles
- Piccadilly Circus - 1.0 miles
- St Pauls Cathedral - 1.3 miles
- London Eye - 1.4 miles
- Houses of Parliament - 1.6 miles
- London Aquarium - 1.6 miles
- Madame Tussauds - 1.7 miles
- Westminster Abbey - 1.7 miles
- Buckingham Palace - 1.8 miles
- London Zoo - 2.2 miles
- The Tower of London - 2.2 miles

### MEETINGS AND CONFERENCE

When you invite colleagues and clients to a meeting at DoubleTree by Hilton London - West End, you can have confidence that everything will run smoothly. Whether you need help setting up a projector, supplying the room with pens and paper or meeting special dietary requirements, our team will be on hand to look after the details, so you can focus on everything else you need to get done. Whether your group is large or small, we've got the perfect space. We'd love to give you a tour of our facilities and show you all the ways we'll help to make your meeting a success.

### MEETING HIGHLIGHTS

- Purpose-built Conference Centre
- 7 state-of-the-art, flexible meeting rooms for up to 100 delegates
- Natural daylight in some of our ground floor rooms
- Complimentary high speed WiFi
- Fully air-conditioned
- Adjustable lighting facility
- The latest audio-visual equipment and communications technology
- Dedicated Operations Manager to assist throughout the day

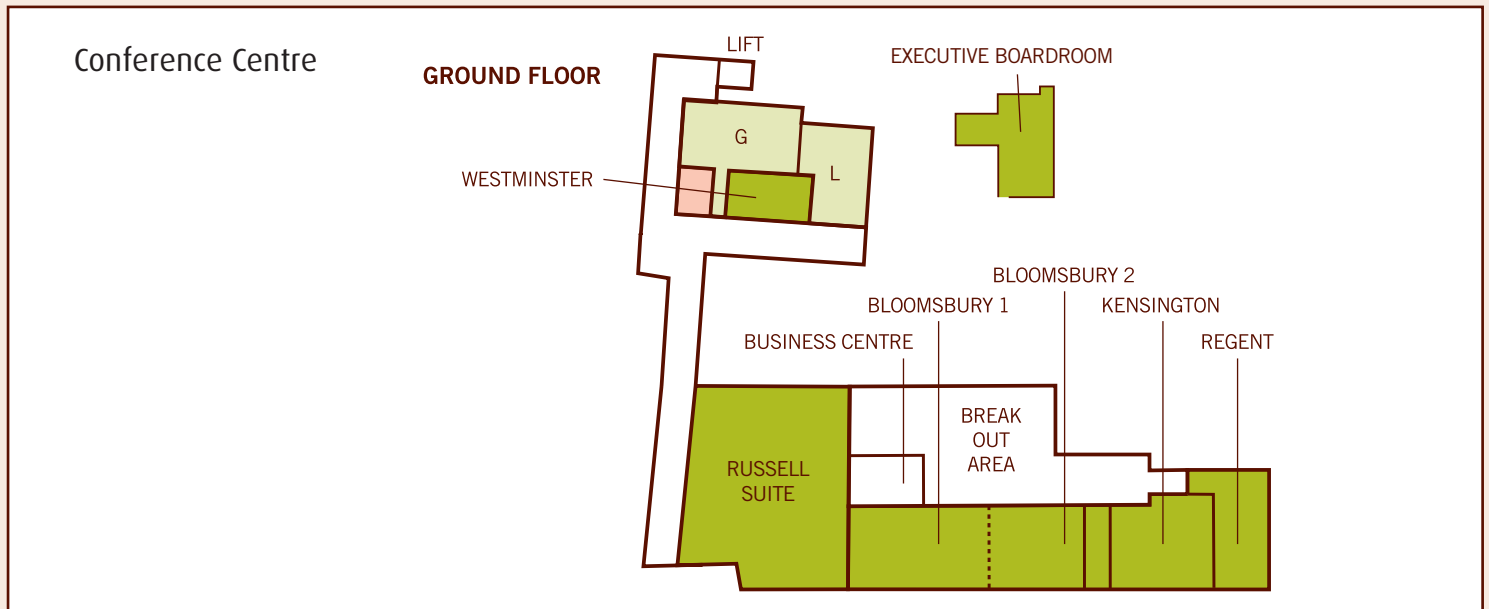

### GROUND FLOOR

Meeting Room/Style	Area (Sq M)	Theatre	Boardroom	Classroom	Cabaret	U-Shape	Hollow Square	Dinner Dance	Dinner	Informal
Russell Suite	98	130	34	52	56	50	32	50	80	100
Bloomsbury Suite	88	60	44	46	48	44	48	40	50	60
Bloomsbury 1	48	50	25	25	25	25	28	-	30	50
Bloomsbury 2	40	35	20	20	20	22	24	-	24	40
Kensington Suite	35	25	20	15	20	18	20	-	20	40
Regent Suite	26	20	10	8	8	-	-	-	10	-
Westminster Suite	15	12	8	-	-	-	-	-	8	-
Executive Boardroom	-	15	10	8	8	-	-	-	12	20

### DOUBLETREE BY HILTON LONDON – WEST END

Southampton Row, London, WC1B 4BH

T: +44 (0) 20 7242 2828 F: +44 (0) 20 7831 9170 E: meetings@dtlondonwestend.com

www.dtlondonwestend.com